

OPTIONS

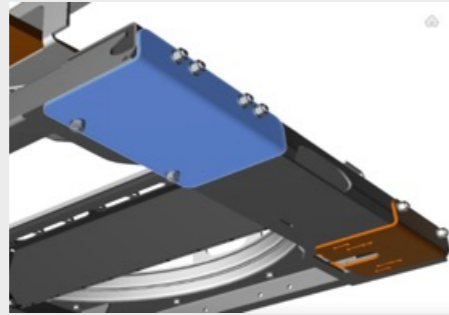

AXLE SEAT HOT-DIP GALVANISED



AXLE BRACKET MOUNTING PLATES

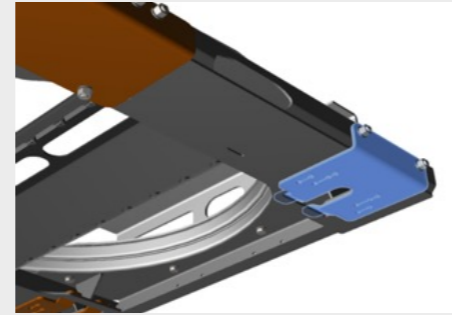

AIR BELOW MOUNTING PLATES

CUSTOMER SPECIFIC OPTIONS

Looking for customer specific options? **Ask your account manager for more information.**



ENGINEERING SERVICE

At IMS Group, we always aim to provide the best and that is why we only supply premium brand products. But we go one step further than that: our R&D department works with trailer manufacturers to design smart technical solutions that will really make a difference. IMS Group employs a number of highly experienced service engineers who provide essential support to both trailer manufacturers and end users. Our engineers can advise on original equipment specifications, offer hands-on assistance during commissioning and help resolve application problems with trailers on the road.

MORE INFO

For more information, please contact our steering systems team at salestrailersystems@group-ims.com or call +31 342 497 881.

IMS Group, Nijverheidsweg 50, 3771 ME Barneveld, +31 342 497 979, www.group-ims.com



IMS Group is the exclusive distributor for a range of premium products, including the leading brands: SAF-Holland, VSE, SEM, GreenSteering & ALEXRIMS. IMS Group supports them with unrivalled sales advice, technical support and aftermarket service.

SEM-SB STEERING SYSTEM



MECHANICAL ROD STEERING SYSTEM FOR TRAILERS

A "SINGLE-BAR" MECHANICAL STEERING SYSTEM THAT STEERS 1 OR 2 AXLES ON YOUR TRAILER



SEM-SB STEERING SYSTEM

Trailer steering is based on a single bar connected to the axle group and a front unit which not only makes the system extremely robust but also reduces the number of components to a minimum. The design, development and construction of new systems take place entirely in the Benelux, ensuring the highest level of quality and durability.

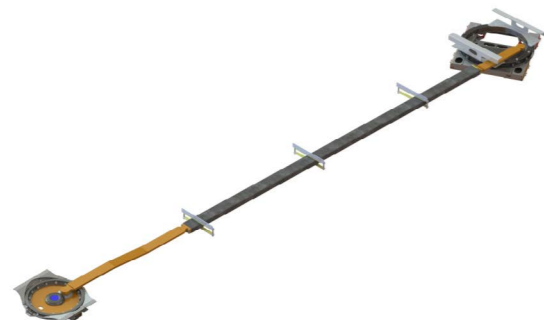

SB1 UNITS

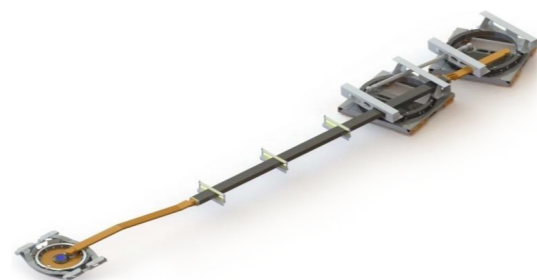

SB2 UNITS

WHY CHOOSE A SINGLE BAR STEERING SYSTEM?

- ✓ The trailer will follow the line taken by the truck more closely so that its movement is more streamlined on bends.
- ✓ Because the trailer follows the line taken by your truck more closely, it also becomes easier to manoeuvre.
- ✓ The improved ease of manoeuvring and the saving on space when taking a bend increases the usability of your trailer.
- ✓ Increasing usability has a direct positive effect on the efficient use of your transport equipment.
- ✓ A trailer steering system reduces the friction when taking a bend.
- ✓ As a result of that reduction in friction, less energy is required leading to savings on fuel consumption and tyre wear.
- ✓ The reduced energy consumption brought about by a steering system on a trailer in turn leads to lower emissions including CO2. Therefore it is better for the environment.

FRONT UNITS

Fifth wheel load	Width	Height	Manufacturing
13 Ton	980mm	90mm	Welding
13 Ton	980mm	90mm	Boltable
13 Ton	1200mm	105mm	Boltable
16 Ton	980mm	90mm	Boltable
16 Ton	1200mm	105mm	Boltable
20 Ton	980mm	135mm	Boltable

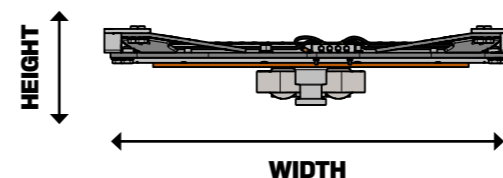

REAR UNITS

Capacity	Axle bracket width
10 Ton	980mm
10 Ton	1200mm

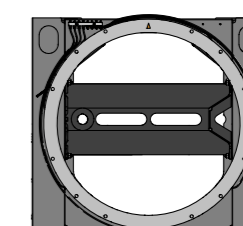

AXLE BRACKET WIDTH

STANDARD OPTIONS

- ✓ Conservation complete in Cathodic dip painting (excluding middle steering bar)
- ✓ Middle steering bar Hot-dip galvanised

